

## Fire Engineering Design

### Structural fire engineering >

A severe fire within a building will affect the structure to some degree. Concrete based structures as well as steel composites normally require some degree of fire protection to prevent the structure heating too rapidly and failing prematurely. Concrete structures can have inherent fire resistance while steel structures can be protected with a board or spray to insulate the structure from fire. Our capability to determine the required fire protection is illustrated below.

#### Aims >

>Provide sufficient fire protection for the specific building's structure to protect it throughout the duration of a fire.

#### Benefits >

>Reduced construction cost (and time) without reducing safety.

>In some cases fire protection can be removed from secondary steel, while the whole structure may be reduced by as much as 60 minutes. A 30-minute reduction is typical for well-vented buildings (i.e. large area of glazing).

>Improved structural resilience with enhanced structural details where appropriate, i.e. sheer stud overlap, composite mesh size and improved column-beam connections.

#### Tools >

>Simple equations for hand calculations, PD 7974-1 for compartment fires.

>In-house zone model analysis for compartment temperatures assessment.

>Time Equivalence Analyse.

>Finite Element Analysis of whole building performance.

#### Projects >

>The Point Development

>Douglas Village Shopping Centre

>Montevetro Tower

>Northern Quarter

>Dundrum Village

>Gloucester St Belfast

>NCC Hotel

>NCC

>Central Criminal Courts

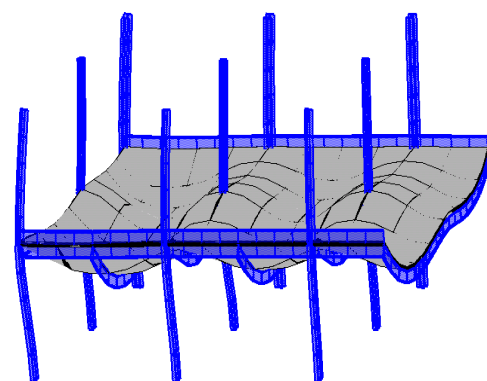
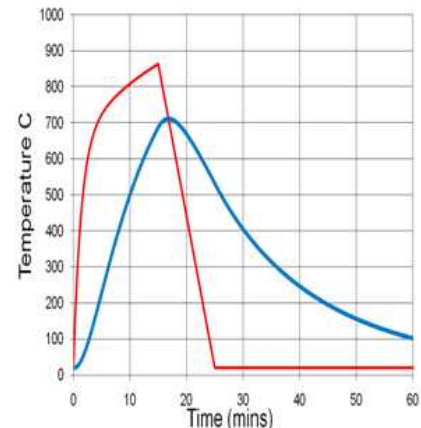

#### >Dublin Office

19 Windsor Place,  
Lower Pembroke Street,  
Dublin 2

Tel: +353 (1)6765713  
Fax: +353 (1)6785247  
Email: dublin@msa.ie

#### >Belfast Office

Scottish Mutual Building,  
Donegall Square South,  
Belfast BT1 5IG

Tel: +44(0)2890312077  
Fax: +44(0)2890312077  
Email: belfast@msa.ie

#### >Leeds Office

Calls Wharf,  
2 The Calls,  
Leeds LS2 7JU

Tel: +44 (0)113 237 2838  
Fax: +44 (0)113 237 2701  
Email: leeds@msa.ie



ACEI  
Association of Consulting  
Engineers of Ireland